

June 11, 2019
 The Secretary,
 Gujarat Electricity Regulatory Commission
 Gift City, Ahmedabad

Subject: Increase of Land area by 18.55.92 Hectares in Existing plot area of 107.16.50 Hectares in the Distribution License of M/s Jubilant Infrastructure SEZ, located at Plot no. 5, Vilayat GIDC, Tal. Vagra, Dist.- Bharuch.

Dear sir,

With reference to the above subject, M/s Jubilant Infrastructure limited SEZ is having a Distribution License issued by the Honorable Commission vide letter No, 02152, dated 11.10.2012, for the demarcated area of 107.16.50 Hectares. The adjoining area of Plot No. 4, admeasuring 18.55.92 hectares has been added in the original area of 107.16.50 Hectares. The notification for the same is received vide letter No. F.2/270/2006-SEZ, dated 27.09.2017 and the respective Lease deed for the same with GIDC has been executed vide letter No.227/22.06.2016.

Respective Survey Nos. in Plot No. 4 are as below-436/P,440/P,441/P,442/P, 443,444,445/P,455/P, 456,457/P and 458/P.

Copies of the received notification from MOCI, Lease deed executed between M.s GIDC & M/s Jubilant Infrastructure limited, Old Distribution License with Map and the Plot Plan including the additional area with survey Nos. is enclosed for your kind perusal and approvals please.

Requesting Honorable Commission to kindly provide the modified License depicting the enhanced area of SEZ with additional plot No. 4, admeasuring 18.55.92 Hectares and oblige.

Kind Regards,

 PRADEEP KUMAR JAIN
 Vice President-SEZ

Enclosed: Copies of:

- o Notification from the MOCI
- o Rectification Lease Deed between GIDC and Jubilant Infrastructure limited
- o Existing Distribution license with plot plan approved by the Commission
- o Updated plot plan including additional area of Plot No. 4.

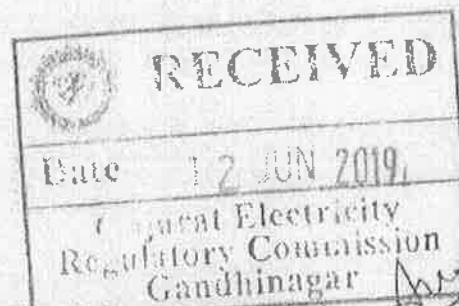

A Jubilant Life Sciences Company

OUR VALUES



Jubilant Infrastructure Limited

SEZ Developer
 Plot No 5, Vilayat GIDC
 Tal - Vagra, Distt. Bharuch - 392 012,
 Gujarat, India
 Tel: +91 2641 281500
 Fax: +91 2641 281513
 www.jubil.com

Corporate Office
 I-A, Sector 16-A,
 Noida-201 301, UP, India
 Tel: +91 120 4361000
 Fax: +91 120 4234895-96

Regd. Office.
 I-A, Sector 16-A,
 Noida-201 301, UP, India
 Tel: +91 120 4361000
 Fax: +91 120 4234895-96
 CIN: U45201UP2006PLC091618



4) **Secretary**

Ministry of Power, Govt. of India
Shram Shakti Bhavan,
Ministry of Power,
New Delhi - I

5) **Secretary**

Ministry of New and Renewable Energy
Block-14, CGO Complex,
Lodhi Road, New Delhi-110 003, India.

6) **Secretary**

Central Electricity Regulatory Commission
3 rd & 4 th Floor, Chanderlok Building, 36, Janpath,
New Delhi- 110001
Ph: 91-11-23353503 Fax: 91-11-23753923

7) **Secretary**

Central Electricity Authority
Sewa Bhawan, Rama Krishna Puram, New Delhi-110066
EPABX: 26732500, Reception (MHA): 26108889

8) **General Manager**

Western Regional Load Despatch Centre
F-3, M.I.D.C. AREA, MAROL,
ANDHERI(EAST), MUMBAI-400093
STD CODE :022, EPABX :28202690

9) **Managing Director,**

Gujarat Urja Vikas Nigam Limited (GUVNL),
Sardar Patel Vidhyut Bhavan,
Race Course,
Vadodara - 390007.

10) **Managing Director,**

Gujarat Energy Transmission Corporation Ltd. (GETCO),
Corporate Office, Sardar Patel Vidhyut Bhavan,
Race Course, Vadodara - 390007

11) **The Chief Electrical Inspector,**
The Office of the Chief Electrical Inspector,
Block No. 18, 6th Floor,
Udyog Bhavan, Gandhinagar.

12) **Under Secretary**
Finance Department
Block No.4, 2nd Floor,
New Sachivalaya,
Gandhinagar.

13) **The Chief Engineer,**
State Load Dispatch Centre (SLDC),
132 KV Gotri Substation compound,
Near T.B.Hospital, Gotri Road,
Vadodara, 390 021, Fax: 0265-2352019

14) **The Managing Director,**
National Load Despatch Centre
B -9, Qutab Institutional Area,
Katwaria Sarai, New Delhi.

15) **Secretary**
Rural Electrification Corporation Ltd.
Core- 4, SCOPE Complex,
7, Lodhi Road,
New Delhi-110003

APPROVED MAP OF THE DISTRIBUTION LICENSED AREA OF SEZ
 JUBILANT INFRASTRUCTURE LTD

VILAYAT INDUSTRIAL ESTATE
 PLOT NO-5

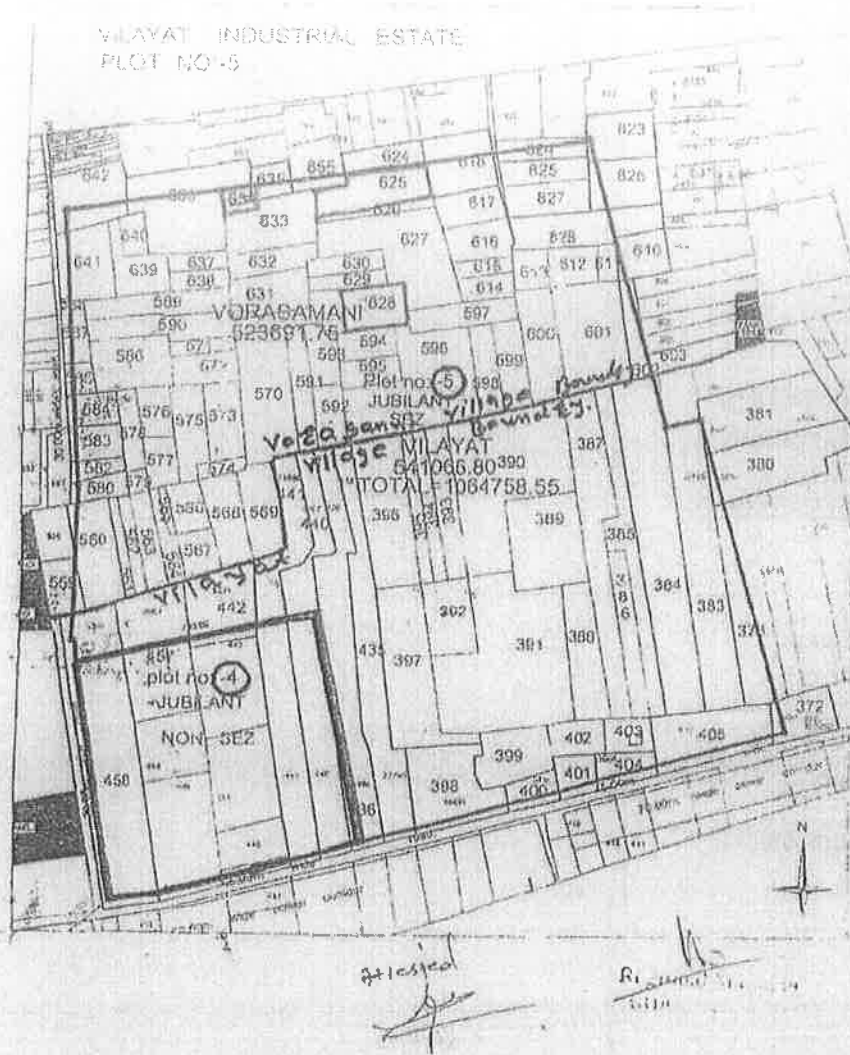

- 1) 634 - The area shown in red marking in the map area not a part of SEZ area as well as distribution licensee of M/s. Jubilant Infrastructure Ltd.
- 2) 625 and 626 - The area shown in green marking in the map are considered as part, i.e. 625 (part) of SEZ area for the distribution licensee of M/s. Jubilant Infrastructure Ltd., as per Notification Number S.O. 290 (E) dated 11.02.2008

[Signature]
 SECRETARY
 GERC